

HOUSE CONNECTION STACK, OPTION 1

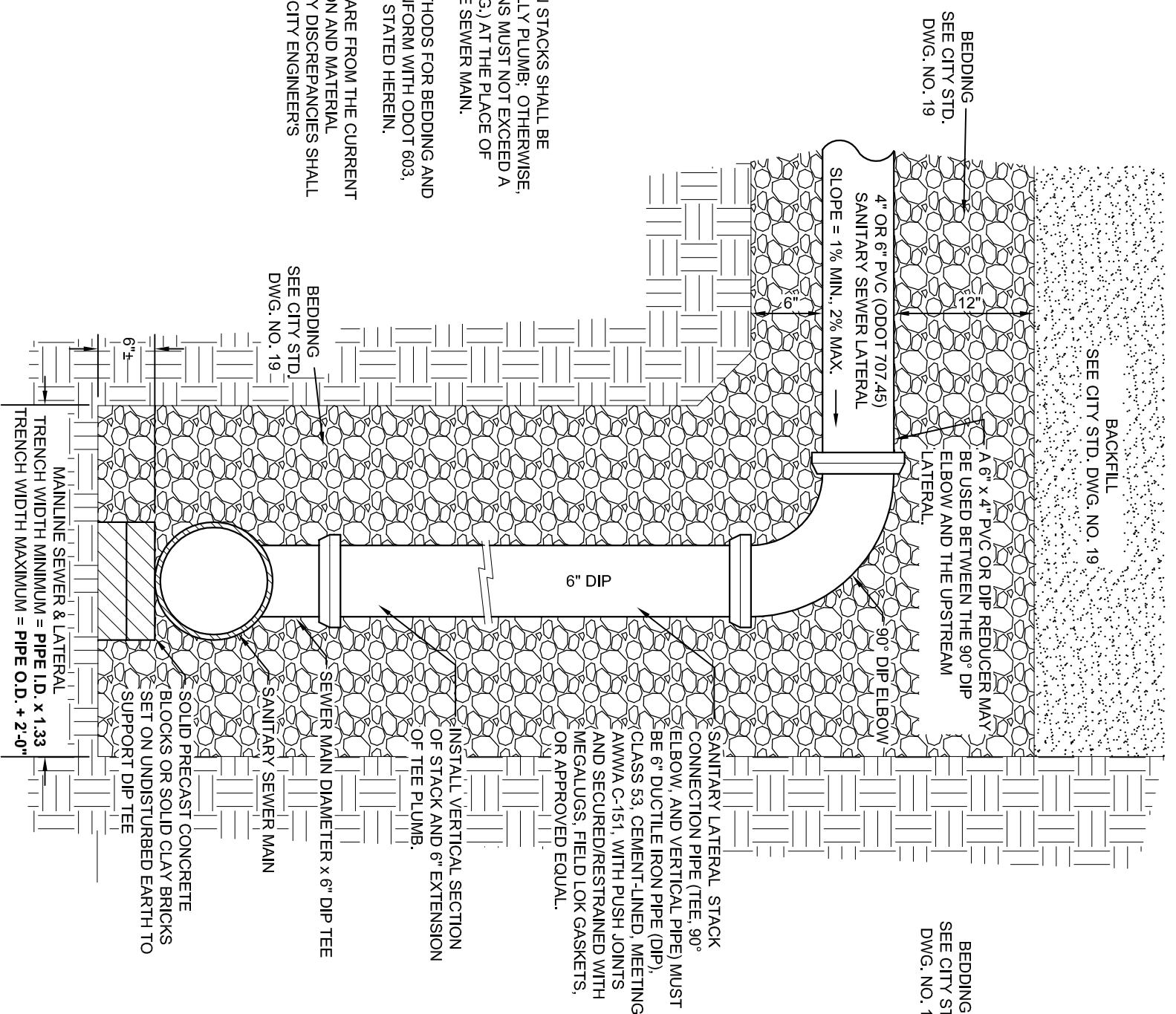

NOTES:

1. HOUSE CONNECTION STACKS SHALL BE INSTALLED VERTICALLY PLUMB; OTHERWISE, SEWER CONNECTIONS MUST NOT EXCEED A SLOPE OF 1:1 (45 DEG.) AT THE PLACE OF CONNECTION TO THE SEWER MAIN.
2. CONSTRUCTION METHODS FOR BEDDING AND BACKFILL SHALL CONFORM WITH ODOT 603, UNLESS OTHERWISE STATED HEREIN.
3. ODOT REFERENCES ARE FROM THE CURRENT ODOT CONSTRUCTION AND MATERIAL SPECIFICATIONS; ANY DISCREPANCIES SHALL BE SUBJECT TO THE CITY ENGINEERS DISCRETION.

HOUSE CONNECTION STACK, OPTION 2

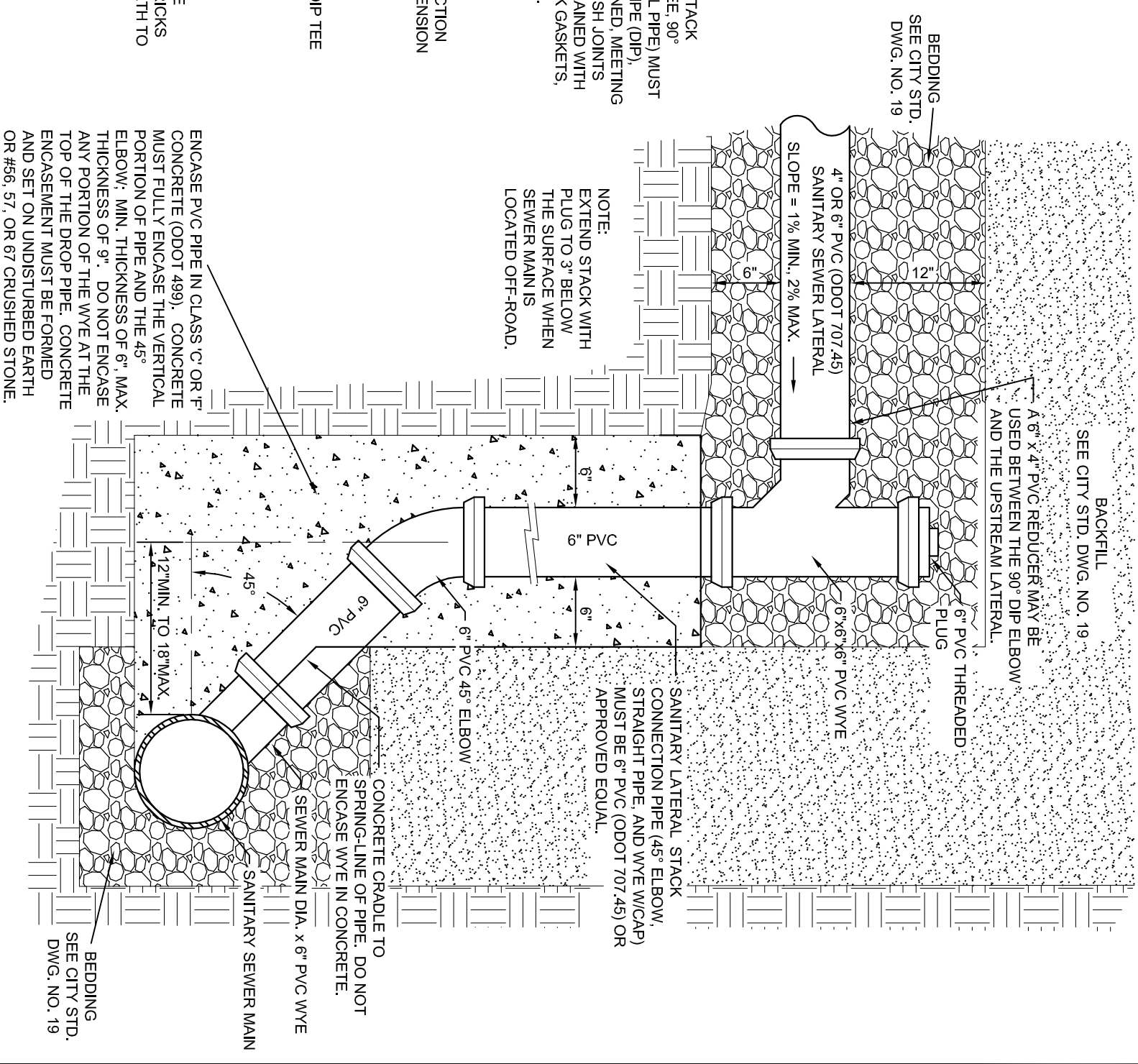

OFFICE OF THE CITY ENGINEER

CANTON, OHIO

DANIEL J. MOEGLIN, P.E., CITY ENGINEER

2436 30th St. NE 44705 330-489-3381

www.cantonohio.gov/engineering

APPROVED DATE: JAN 2012
 APPROVED BY: CDB, RMB, SLH
 DRAWING FILE NAME: ce_18.dwg

REVISIONS

DESCRIPTION	DATE	BY

STANDARD DRAWING NO. 18

HOUSE CONNECTION STACK

